



SAFETY NOTICE

FORKLIFT OPERATORS MUST FOLLOW DIRECTIONAL SIGNAGE WHEN OPERATING ON THE MARKET SITE

Due to an incident in which a forklift operator drove up the wrong side of the roadway within a canopy hitting a pedestrian, SML again reminds you of the importance that all forklift operators and tenants/employers of forklift operators must ensure that operators of all vehicles (including forklifts) follow all directional signage at all times.

It is important that all stakeholders be aware that SafeWork NSW is focused on forklift activity and traffic management at Sydney Markets. All stakeholders have a Work Health and Safety (WHS) responsibility and obligation to their workers and visitors to the Market.

The following information is provided to assist stakeholders to comply with their WHS requirements, although is not exhaustive. Each stakeholder needs to have their own systems in place which comply with applicable WHS laws in order to keep individuals safe.

- Forklift drivers must exercise caution at all times whilst operating a forklift on the Sydney Markets site and drive to conditions.
- Forklift operators **must follow directional arrows on roadways** when operating a forklift in the canopies behind Buildings A, B and C (**see diagram over for example**). "Shortcuts" are not appropriate nor are they permitted and may in fact increase WHS risks to individuals.
- When working on the roadway at the rear of a Wholesale business in Buildings A, B and C, you may horizontally travel across the directional arrows (for example when loading a truck that is on the roadway under the canopy, or moving a pallet) only where it is considered reasonably practicable and safe to do so. However, forklift operators, tenants and transport companies should evaluate the risk of such crossing before undertaking this task as the safety of others whilst they carry out their own work practices is their responsibility.
- Forklifts must be operated at a safe speed at all times (the speed limit is **10kph** in covered areas on the Market site).
- Slow down on wet and slippery surfaces and at cross walkways or locations where vision is obstructed.
- Forklift Operators entering a building or nearing a blind corner must make their approach at reduced speed and proceed cautiously.
- **RMS Road Rules must be adhered to at all times.**

In the interest of safety, directional arrows and other road signage should be followed at all times.

For further information please speak with a Market Officer or the Team Leader on 0407 325 230.

JOHN PASCUCCI

Work Health and Safety Manager
31 March 2017

SEE OVER →

DIRECTIONAL SIGNAGE BUILDINGS A, B & C CANOPIES

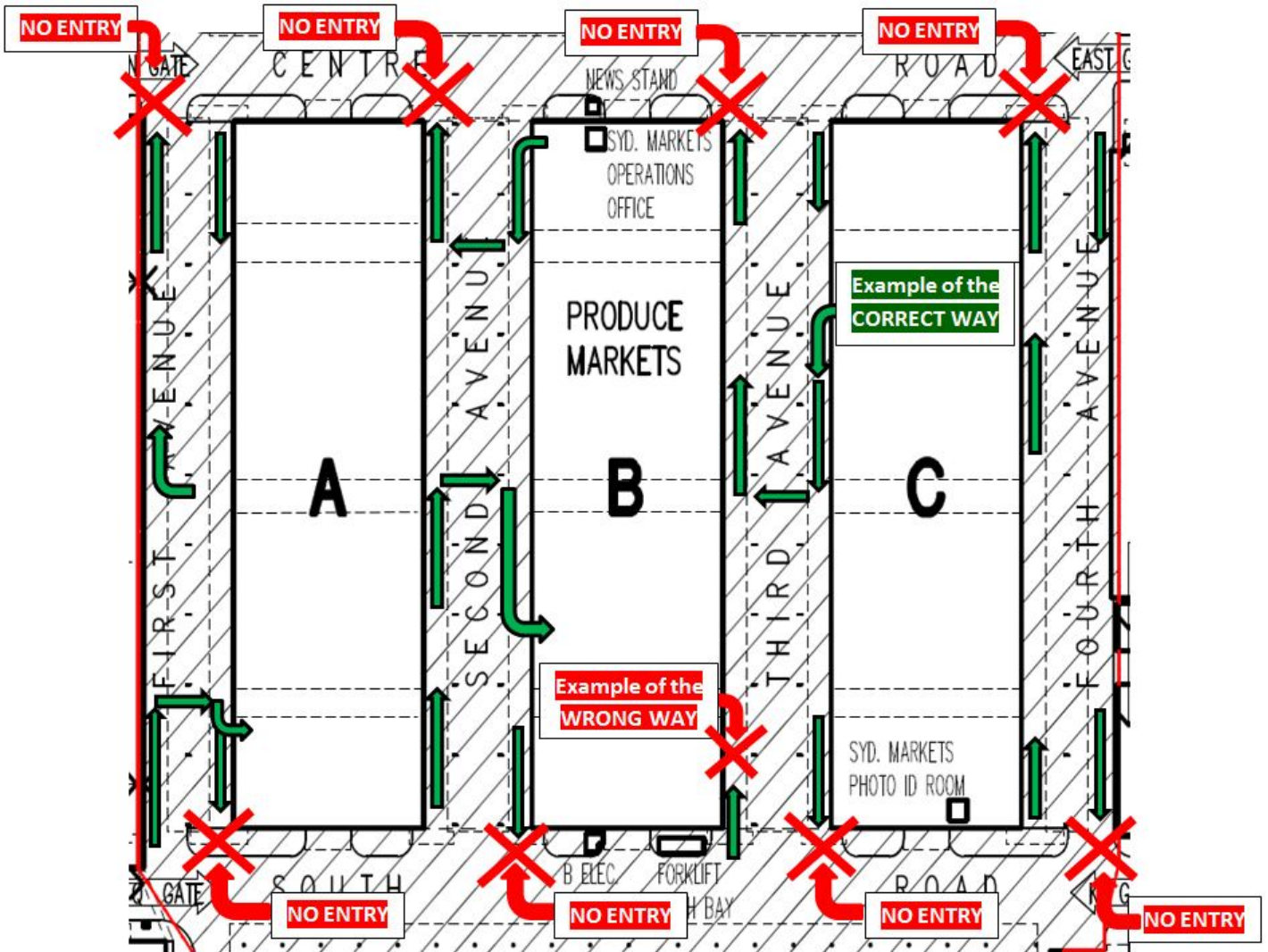

This diagram illustrates how forklifts should travel within the canopies to follow directional markings.

(Note: The green lines indicate the correct travel of forklifts travelling through canopies, to dockways and rampways.)

(Note: The red lines indicate the incorrect travel of forklifts travelling through canopies, to dockways and rampways.)

Slow Down - Buckle Up - Stay Safe
Be Responsible – Be Safe